

# Adjustable Thermostat

## Installation

To install your adjustable thermostat, remove the drain cock from the radiator and replace it with the 1/4" pipe thread fitting. Slide the brass hex nut, followed by the compression sleeve, over the end of the sensor tube.\* Insert the sensor tube into the 1/4" pipe thread fitting and hand tighten the connections until snug.\*\* Do not over tighten! This could damage the sensor. Note that the sensor tube must remain submerged in coolant at all times after installation.

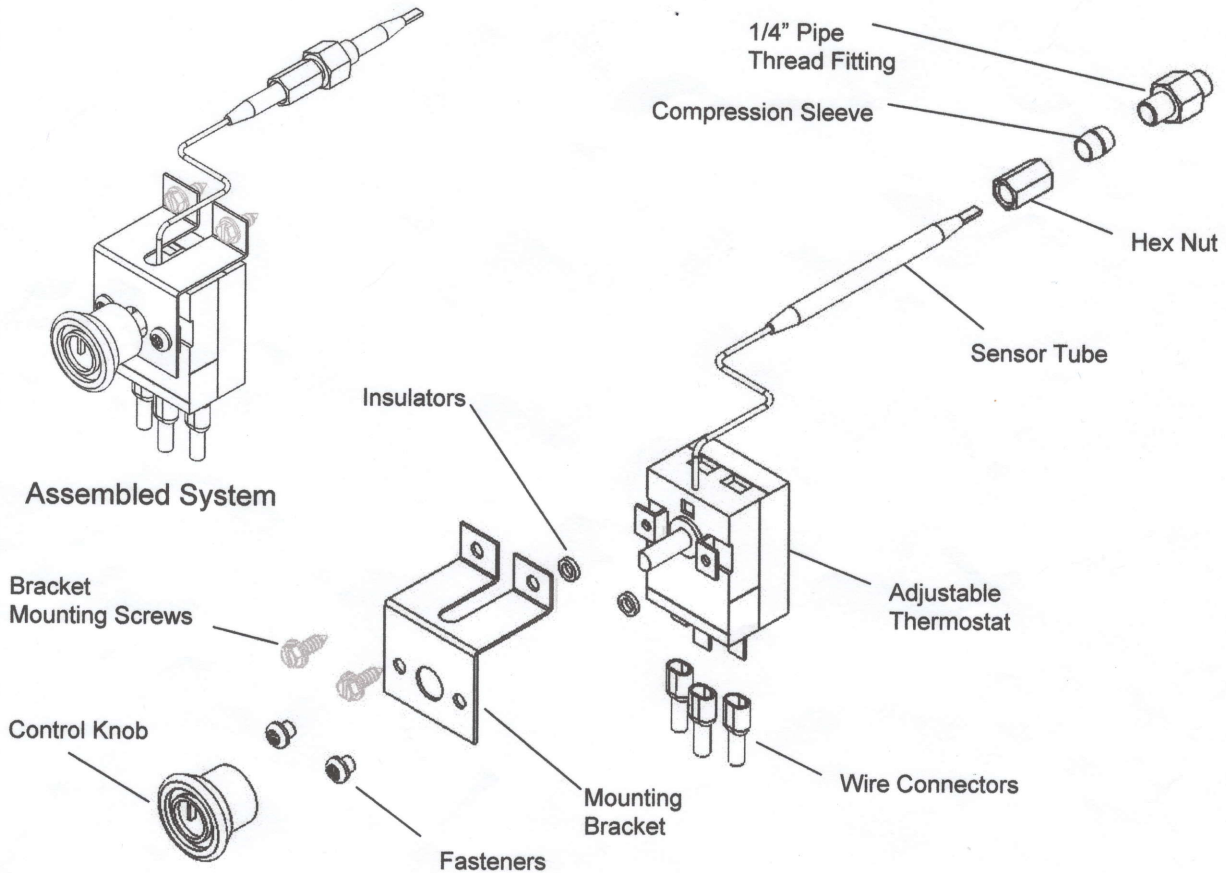

\* Position the compression sleeve to allow 2 inches from its center to the tip of the sensor tube before tightening.

\*\*Carefully tighten using the proper sized wrenches.

## Wiring

For best results, fuse the fan with a 20 amp fuse.

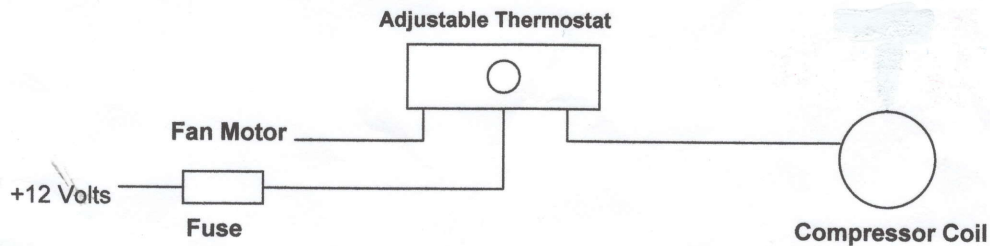

## Calibration

Calibration may vary, depending upon the location of the sensor tube. It is recommended that the engine be started after completion of installation and wiring. After the water temperature is reached which will initiate fan operation as you desire, turn the thermostat's control knob until the fan starts. Your fan is now ready to operate at this temperature.